

910461

CAVO/CABLE
2x2,5
2000 mm
(901208.01)

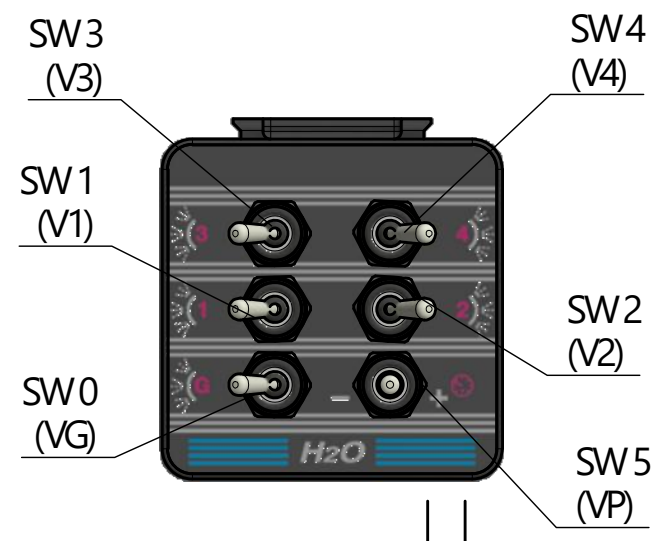

VISTA/VIEW
POSTERIORE/
REAR

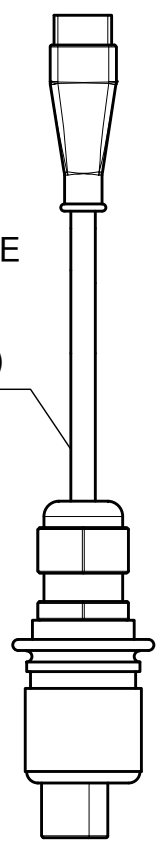
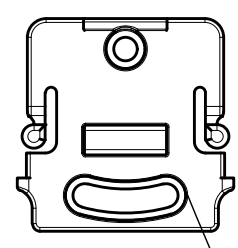

760382

CONNETTORE/CONNECTOR
12 POLI MATE'N-LOCK
FASTON FEMMINA/FEMALE

770196

CONNETTORE/CONNECTOR
12 POLI MATE'N-LOCK
FASTON MASCHIO/MALE

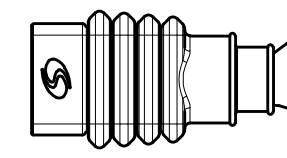

DA ORDINARE A PARTE
TO ORDER SEPARATELY

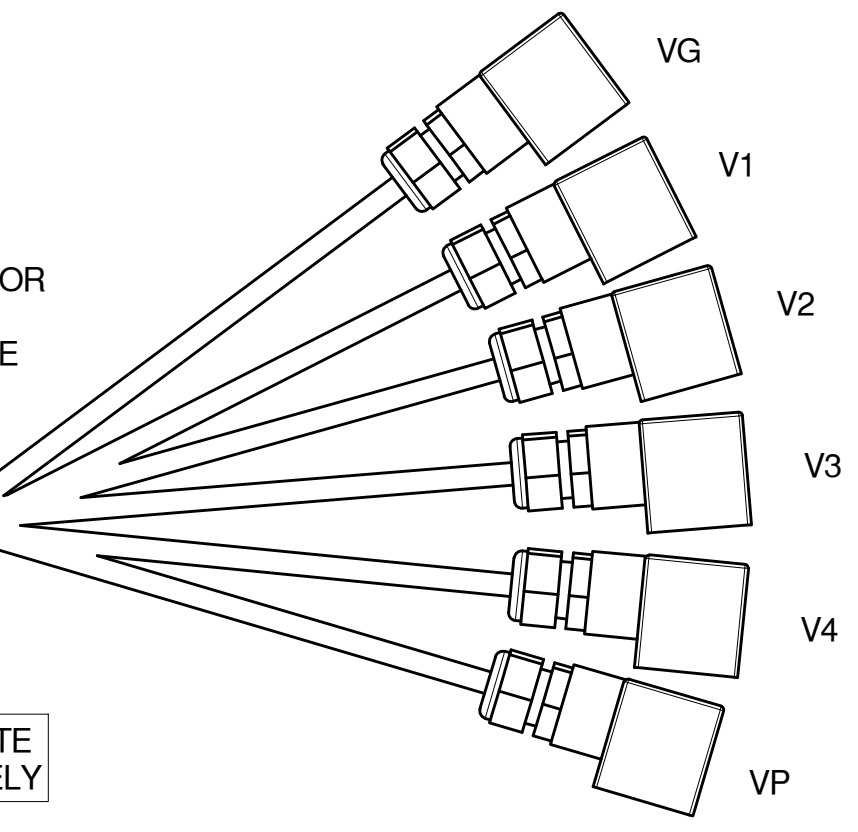

N°5 CONN.
C11
3 FILI

N°1 CONN.
C11
2 FILI

CONNETTORE/CONNECTOR
12 POLI MATE'N-LOCK
FASTON FEMMINA/FEMALE

- 919049-3,0 (3000 mm)
- 919049-5,0 (5000 mm)
- 919049-7,0 (7000 mm)
- 919049-9,0 (9000 mm)

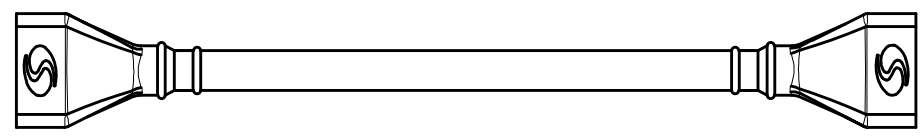

CONNETTORE/CONNECTOR
12 POLI MATE'N-LOCK
FASTON MASCHIO/MALE

DA ORDINARE A PARTE
TO ORDER SEPARATELY

770195

CONNETTORE/CONNECTOR
12 POLI MATE'N-LOCK
FASTON MASCHIO/MALE

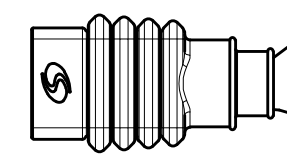

DA ORDINARE A PARTE
TO ORDER SEPARATELY

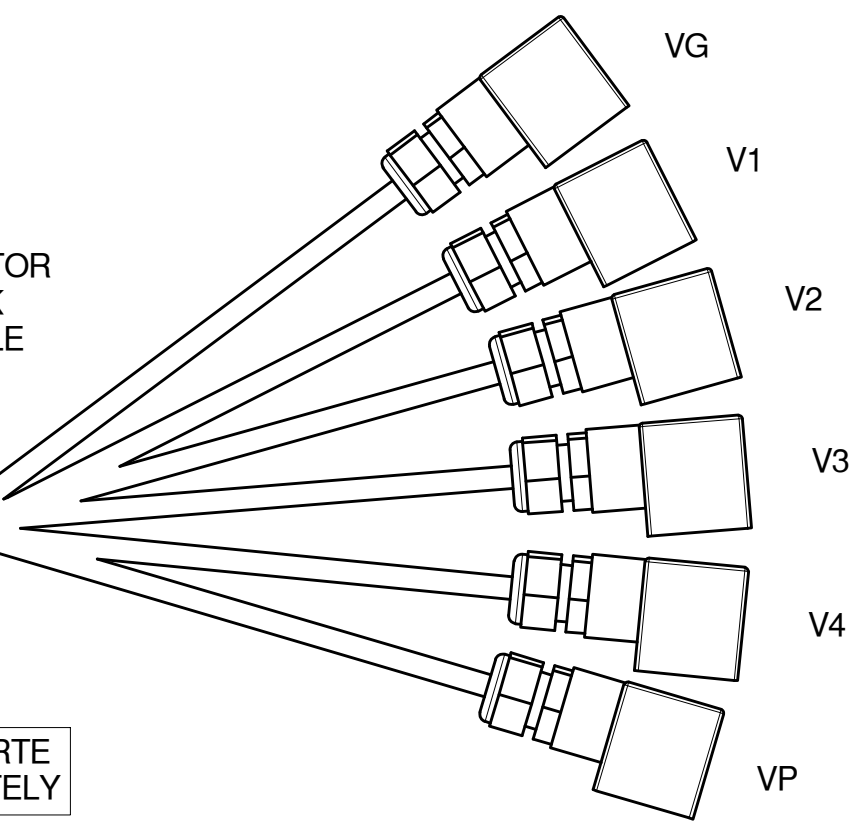

N°5 CONN.
C18
2 FILI

N°1 CONN.
C11
2 FILI

OPTIONAL

BL-400504

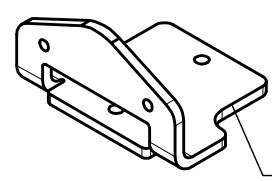

760418

Descrizione:
KIT BOX P90 G-4-VP + NFC

Materiale: Peso:
0,60



Data: 17/03/21	Scala: 1:2	Tratt. Superficiale:
Disegnatore: Ferrarini	Tratt. Termico:	
Lavorazioni non quotate: Smussi non Quotati: 0.5x45° Raccordi non Quotati: 1	Disegno: 910461	Rev.: 0